



The *Slide 01* product from 3form is a wall mounted sliding panel assembly. With a new and improved design, installation is easier and the resulting appearance is more cleanly defined while retaining a minimalistic approach to ensure the hardware complements the panel.

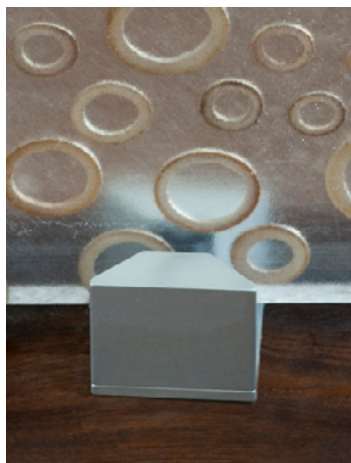

Table of Contents

1 Overview

3 Additional Considerations

6 ADA Compliance

7 Features

- 7 Easy Mount Track
- 7 Ease of Installation
- 7 Floor Pin and Recessed Track
- 7 Frameless Construction
- 7 Satin Anodized Finish

8 Solutions

- 8 Kit A Description
- 9 **Kit A Example 1:** Single Door, Offset
- 9 **Kit A Example 2:** Single Door, Aligned
- 10 Kit B Description
- 11 **Kit B Example 1:** Double Panel Opening
- 12 **Kit B Example 2:** Adjacent Wall Opening

13 Installation

- 13 Components List
- 14 **Kit A:** Floor Mounted Guides
- 23 **Kit B:** Floor Track

For Assembly Instructions Turn Directly to Page 13

Overview

Kit A (Single Panel Kit with Floor Mounted Guide)

Kit A addresses a single panel installation with a panel size of up to 48" wide. The single panel kit includes (1) 96" length of the 2 piece top track with end pieces, (2) top roller assemblies, (1) floor mounted bottom guides with rollers, (1) floor mounted receiver, (2) Handle/Stiffeners and (2) double stop/bumper and requires (1) panel. The desired overlap of the panel to the opening is easily adjusted via the 2 adjustable stops. See page 8 for more information.

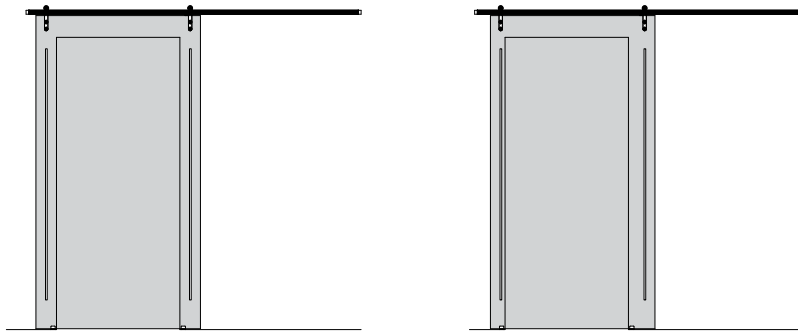

Kit B (Single Panel Kit with Pin and Recessed Track)

Like Kit A above, Kit B includes a pin & recessed track instead of the floor mounted guides. Suitable for single panel openings where a track is required and for openings requiring 2 panels (requires 2 kits). See page 10.

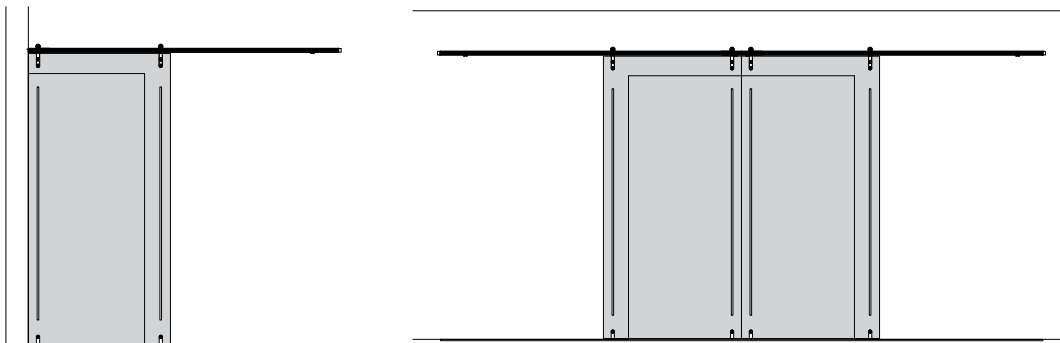

Custom Configuration

With the components available in the slide wall mount system, a variety of other installations may be addressed. Pick and choose the components you need to put together the installation you want.

Parts Overview

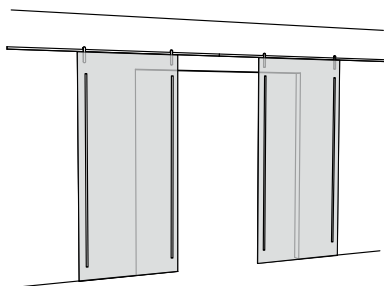
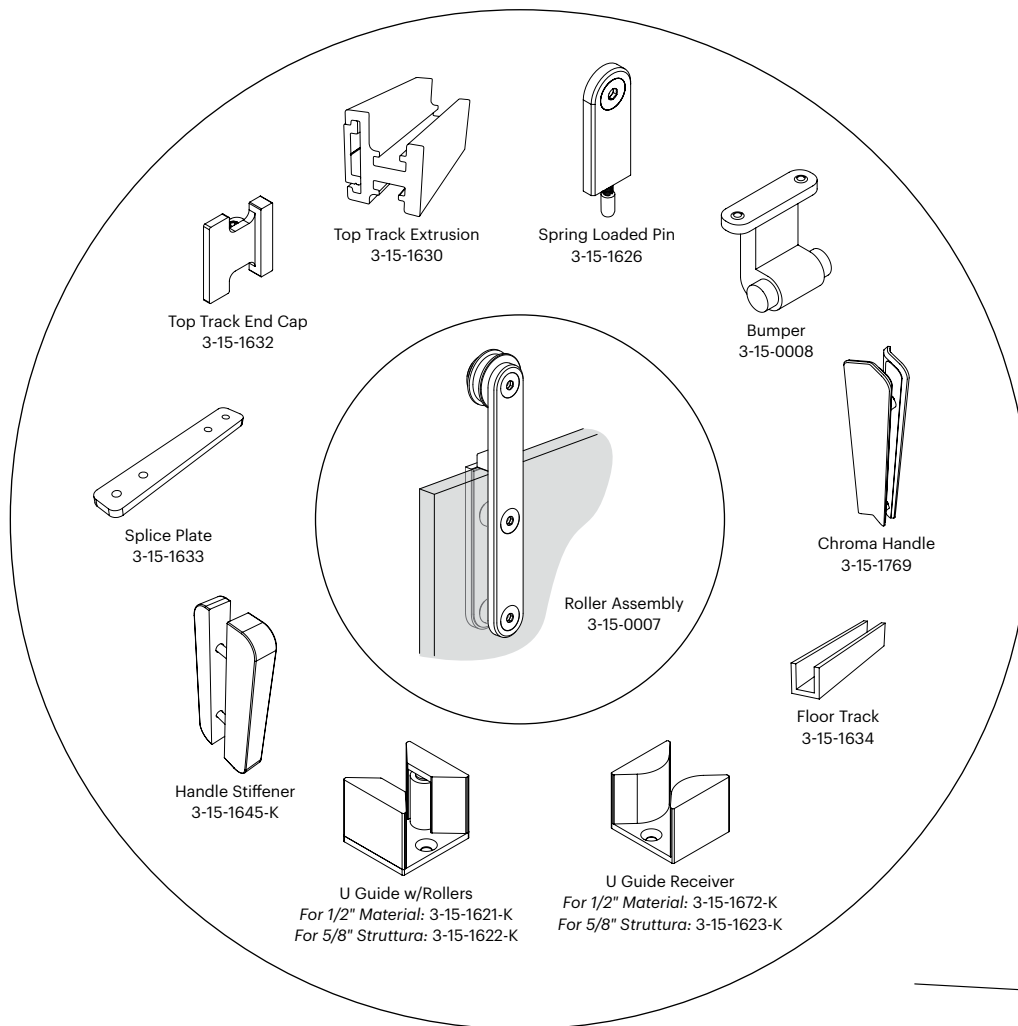

Two Doors / Wall Mount System

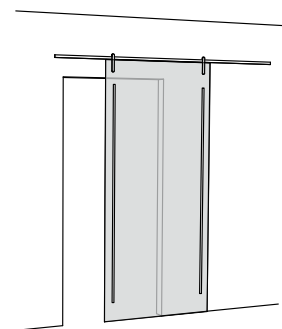

One Door / Wall Mount System

For size dimensions and detail of parts go to:
<http://www.3-form.com/hardware-catalog-Slide01.php>

Additional Considerations

Travel

The dimensions given in this documentation, referring to the kits and regarding the placement of the double stop, length of track used, panel size, and position of the track stops in the track (6" from either side of a 44" wide panel), result in a 40" travel. For example, in the illustration below, when the panel is closed, there is a 4" overlap on a 36" wide opening. In the open position, the panel is flush with the opening. The difference, or travel, is 40".



For most installation purposes, the travel is easily adjusted on the spot simply by sliding the track stops to the appropriate position for both the open and the closed position.

Gauge

The roller assembly, floor guides, and handles are designed to work only with ½" Varia or Chroma. This gauge is chosen to minimize deflection in a hanging panel condition.

Track

The track included with the kits is easily fabricated on-site. Prior to fastening track to the wall, determine required spacing for fasteners, mark, and counter-sink with a standard 82 degree countersunk bit.

Additionally, each track may be joined with an adjacent track via the splice plate. This allows 2 tracks to be joined together when longer spans of track are required.

Additional Considerations

Clearance

When installing the wall mounted track, you will need 3" (~76 mm) clearance between the lower edge of the track and the ceiling to allow for installation of the track and panel.

When installed, there is approximately 2.94" (74.6 mm) distance between the top off the roller and the top of the panel suspended beneath.

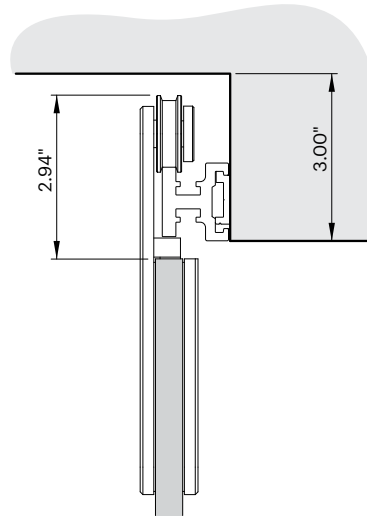

The bottom condition may vary depending on your use of either the U Guide option or the pin and track option.

When using the U Guide, ensure that the panel dimension will allow for a $\frac{3}{16}$ " Min clearance between the panel and the floor and a max clearance of $\frac{7}{8}$ ". This will ensure the proper engagement between the panel and the guide.

When using the pin and track option, a $\frac{1}{8}$ " Min clearance and $\frac{5}{8}$ " Max clearance between the floor and the panel should be used.

In most situations, the height positioning of the track can easily be determined on site to allow for proper clearance at the bottom.

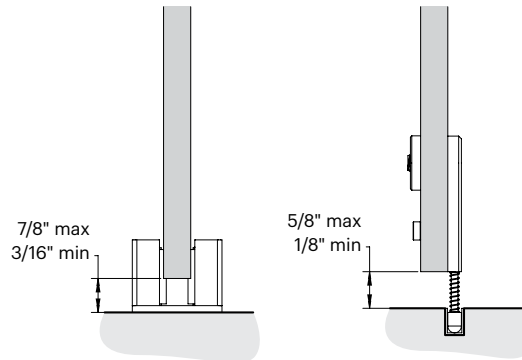

Additional Considerations

Clearance

Clearance from the wall to the panel and the stiffener handle are shown here. In addition, the dimensions of the Chroma handle are the same as the Stiffener handle, so this dimension is appropriate to understand clearance for light switches, trim work, etc.

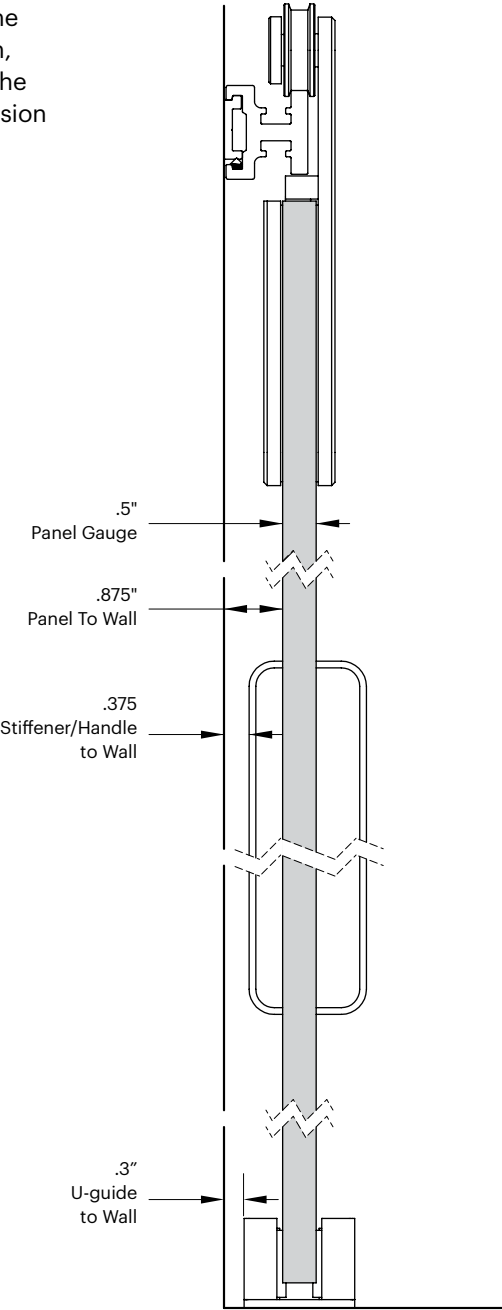

Additional Considerations

ADA Compliance

Per the Department of Justice ADA Regulations, the following guidelines should be considered in the design of your custom *Slide* solution when used to treat doorway openings:

4.5.2 Changes in Level

Changes in level up to ¼" (6 mm) may be vertical and without edge treatment (see Fig. 7(c)). Changes in level between ¼" and ½" (6 mm and 13 mm) shall be beveled with a slope no greater than 1:2 (see Fig. 7(d)). Changes in level greater than ½" (13 mm) shall be accomplished by means of a ramp that complies with 4.7 or 4.8

4.13.5 Clear Width

Doorways shall have a minimum clear opening of 32" (815 mm) with the door open 90°, measured between the face of the door and the opposite stop .

4.13.8* Thresholds at Doorways

Thresholds at doorways shall not exceed ¾" (19 mm) in height for exterior sliding doors or ½" (13 mm) for other types of doors. Raised thresholds and floor level changes at accessible doorways shall be beveled with a slope no greater than 1:2 (see 4.5.2).

4.13.9* Door Hardware

Handles, pulls, latches, locks, and other operating devices on accessible doors shall have a shape that is easy to grasp with one hand and does not require tight grasping, tight pinching, or twisting of the wrist to operate.

*Lever-operated mechanisms, push-type mechanisms, and U-shaped handles are acceptable designs. When sliding doors are fully open, operating hardware shall be exposed and usable from both sides. Hardware required for accessible door passage shall be mounted no higher than 48" (1220 mm) above finished floor.

Please refer to the following website for more information and diagrams:

<http://www.usdoj.gov/crt/ada/reg3a.html#Anchor-Appendix-52467>

Kits A and B may be configured to meet ADA compliance. If an ADA compliant solution is required, please consult your 3form sales rep to customize your Slide WM solution to the opening you are treating to ensure the requirements above are met.

Features

Easy Mount Track

Existing rail system-based wall mounted sliding doors rely on fasteners that bolt through the track. This means the track must be pre-drilled, which may or may not correspond to the spacing of the wall framing. Additionally, the fastener heads may be left exposed. With this proprietary 2-part track, the wall mounted portion may be drilled on site to match up exactly with your wall framing or wood blocking. Additionally, the 2 part assembly ensures that the fasteners are always hidden.

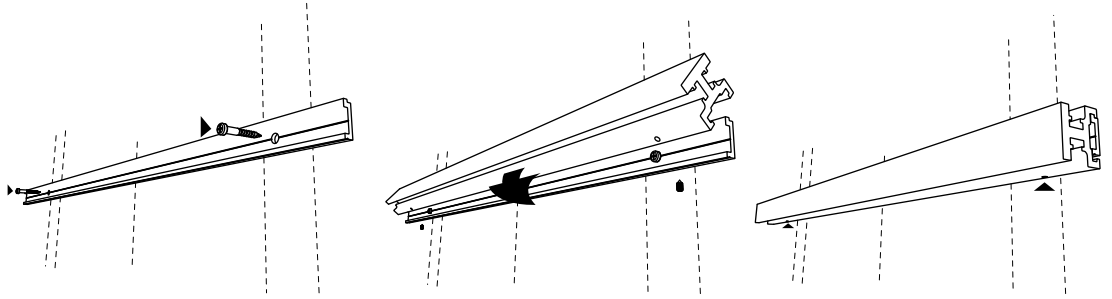

Ease of Installation

Installation is completed in three simple steps. First, mount the track to the wall. Second, attach roller assemblies to the panel. Last, hang the door on the track. For more complete installation instructions refer to the installation manual.

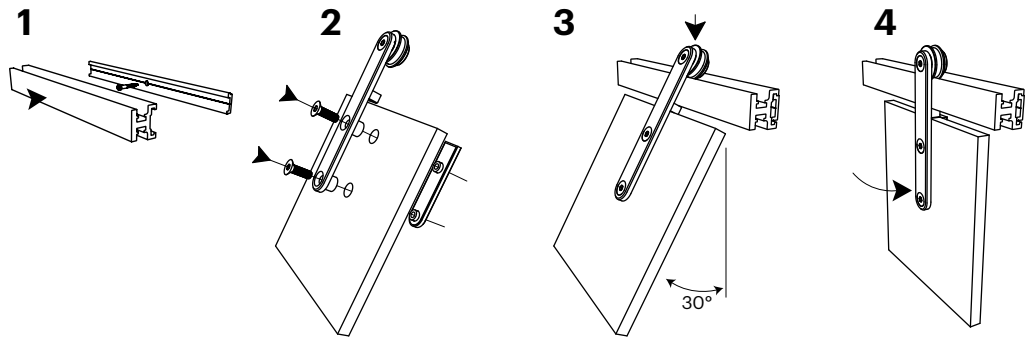

Floor Pin and Recessed Track

The optional recessed track and floor pin allows for a functional guide that can accommodate for variations in your floor evenness. The spring pin can adjust up to $\pm \frac{1}{2}$ ".

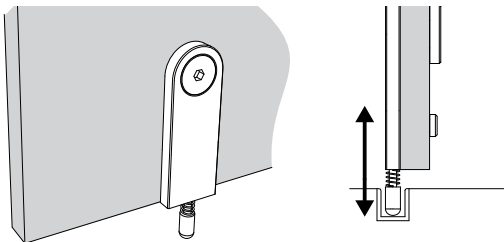

Frameless Construction

The freely suspended frameless construction highlights the panel, not the hardware.

Satin Anodized Finish

The satin anodized finish on both the track and the roller assembly match beautifully with one another. Additionally, it removes the necessity of a valance to cover an unfinished track.

Solutions

Kits

As explained earlier, Slide wall mount is available in two different standard configurations, Kit A and Kit B. However, the components can be purchased individually and the tracks joined together for installations in which the standard kits may not be the ideal solution. Use the solutions below as a template for your installation or as the basis of your own design.

KIT A: Description

The simplest solution is a single panel mounted over a standard door size opening.

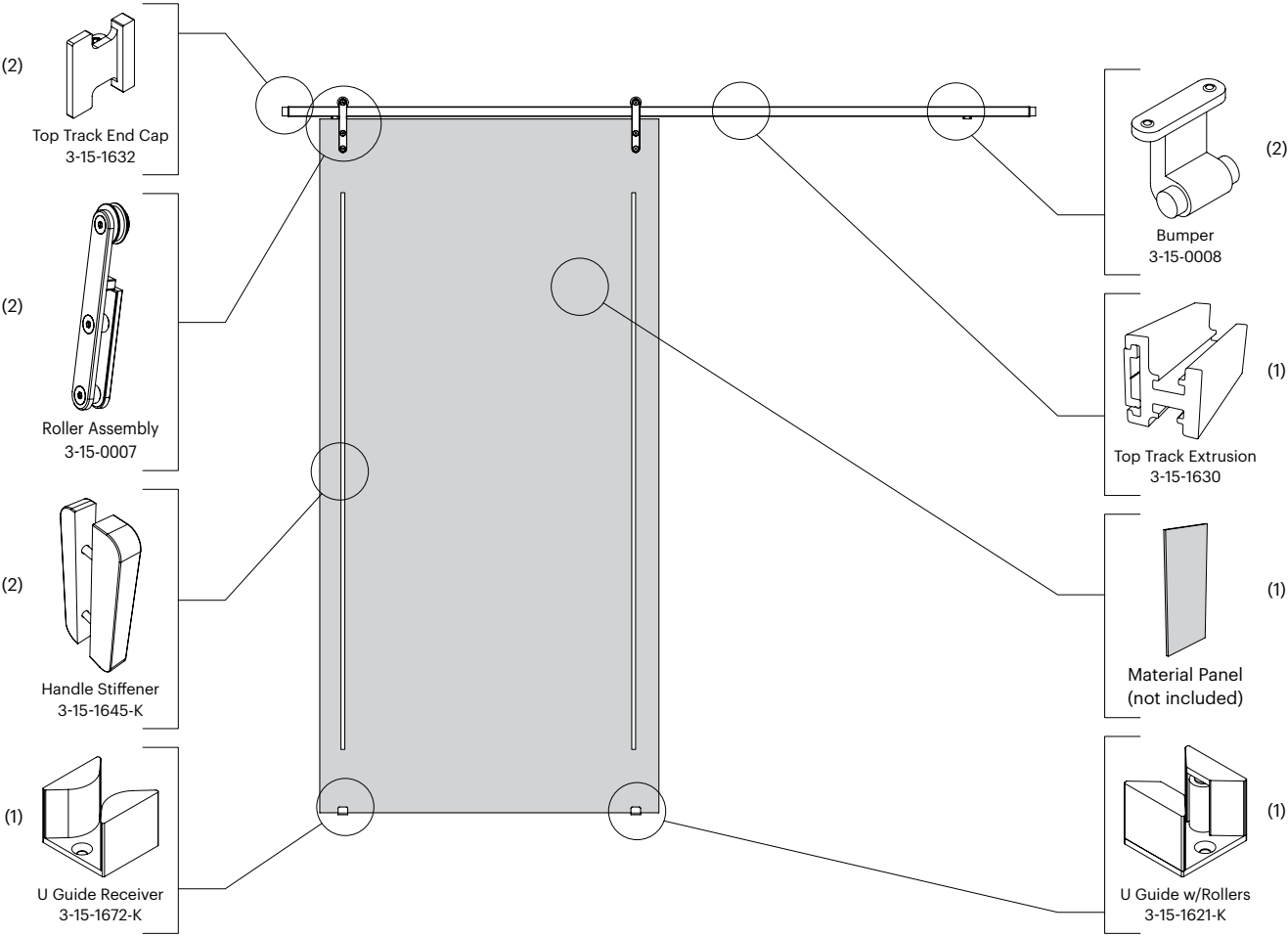

Kit A includes the components shown, except for the required panel. For full kit contents and installation instructions, refer to the Installation document.

KIT A

Example 1: Single Door, Offset

Depending on the placement of the track in relation to the door frame, a variety of configurations may be addressed. For this depicted option, the open door aligns with the edge of the opening. But the panel is offset from the opening in the closed position. Possible dimensions are shown for reference.

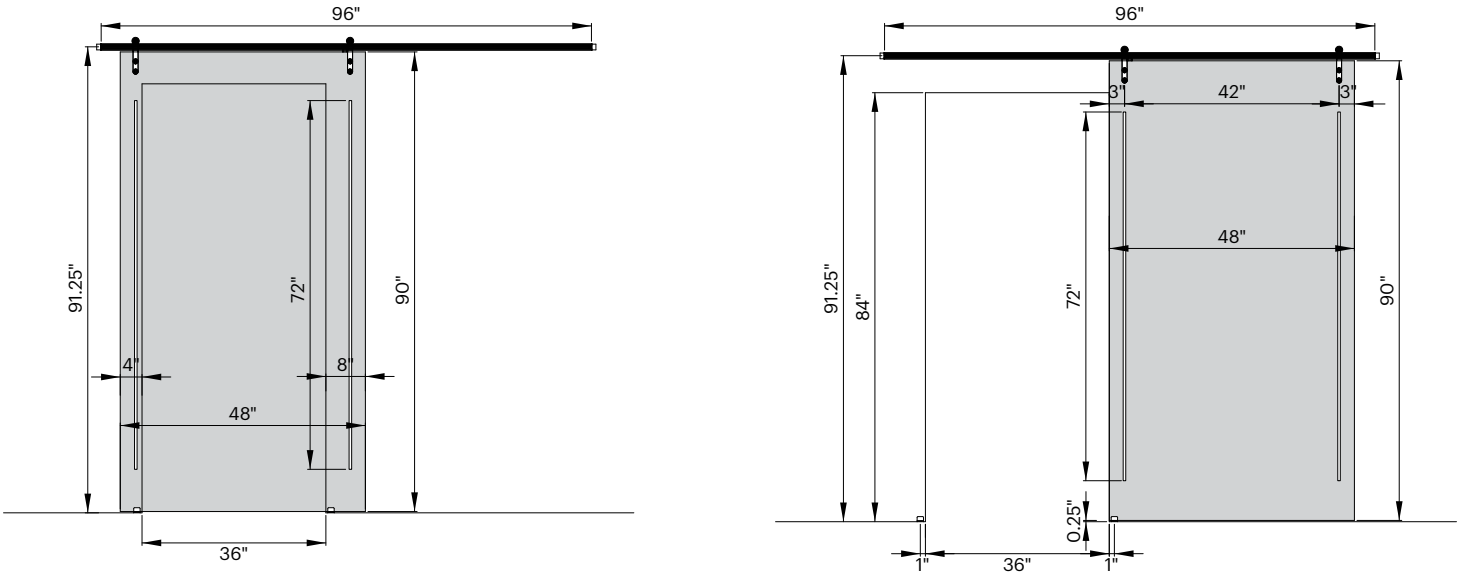

Example 2: Single Door, Aligned

In the example below, the overlap between panel and opening is evenly spaced in the closed position, but there remains a slight overlap between panel and opening in the open position. Possible dimensions are shown for reference.

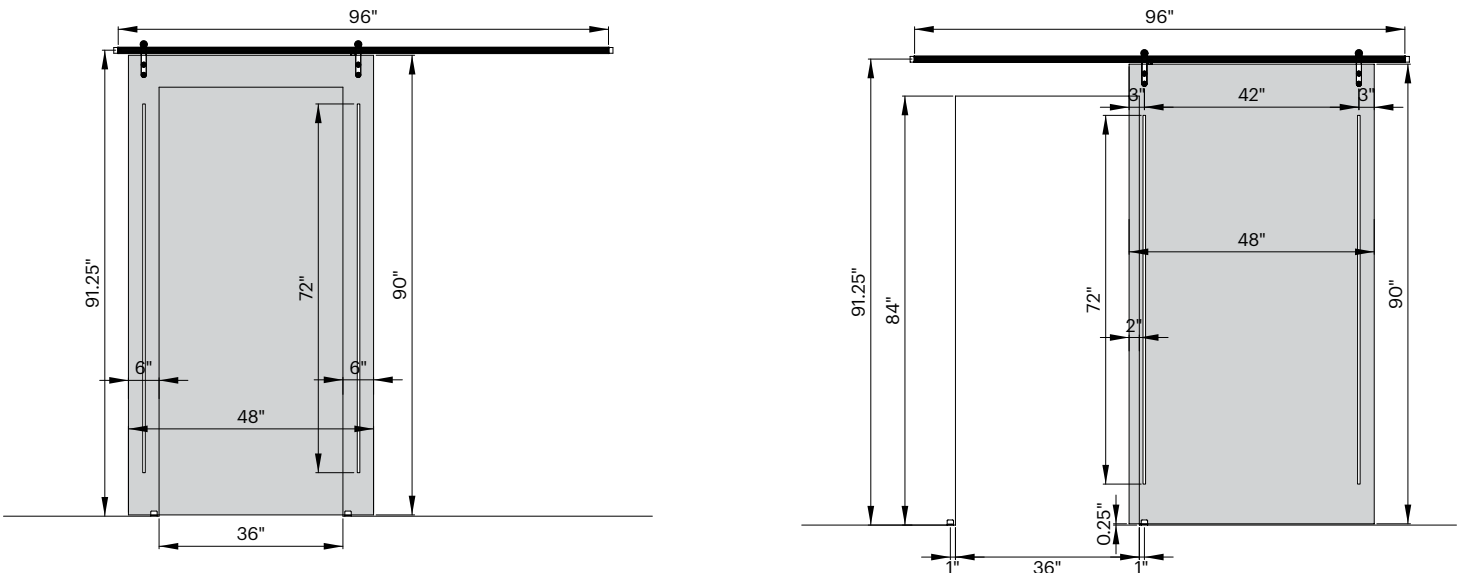

KIT B: Description

Kit B is identical to Kit A except for the inclusion of a recessed floor track, rather than the floor mounted guides. It is suitable for a double wide opening or when the edge of the panel must butt up against a wall.

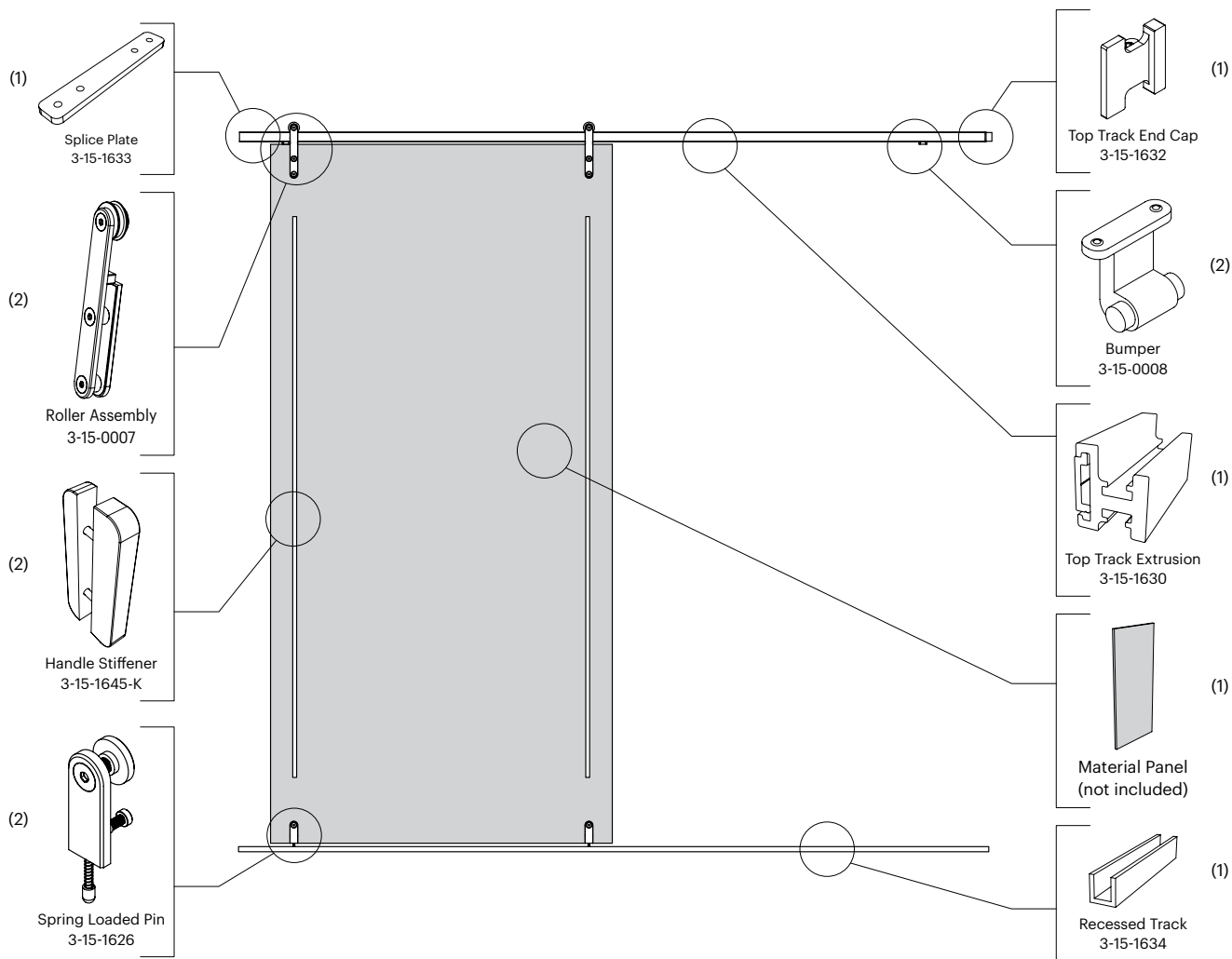

Kit B includes the components shown, except for the required panel. For full kit contents and installation instructions, refer to the Installation document.

KIT B

Example 1: Double Panel Opening

As with Kit A, Kit B can address a variety of configurations and options depending on how the wall mounted track is placed. The option below requires 2 "B" Kits, spaced next to one another to cover the 6' wide opening. Possible dimensions are shown as reference.

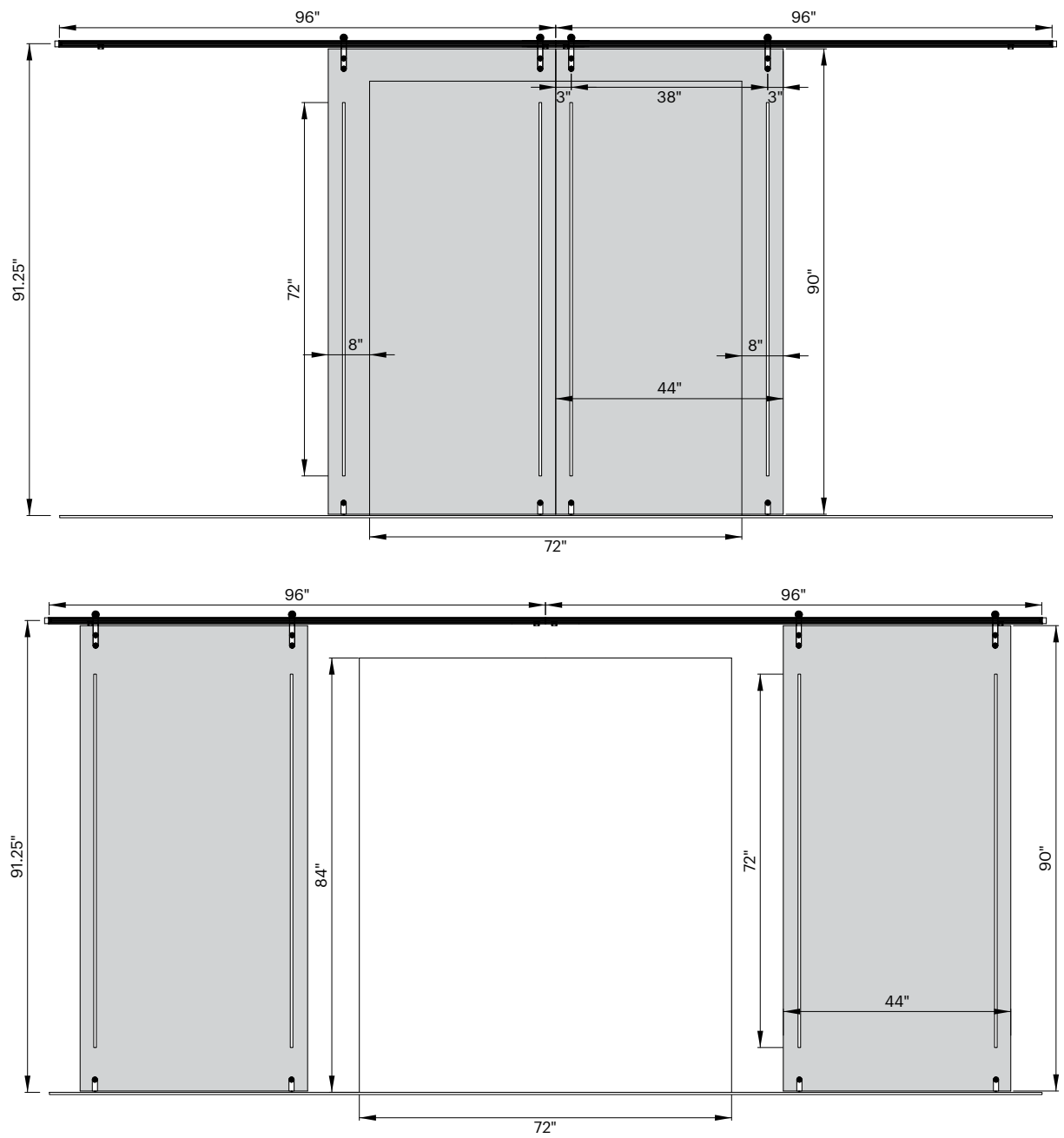

KIT B

Example 2: Adjacent Wall Opening

In the diagram below, the door opening is adjacent to the wall. In the open position, the stop may be located to create any desired amount of overlap with the opening. Possible dimensions are shown for reference.

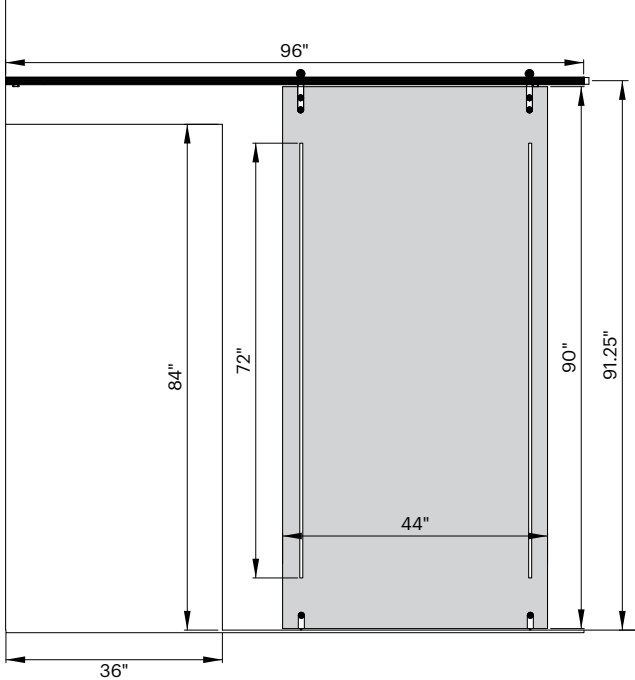
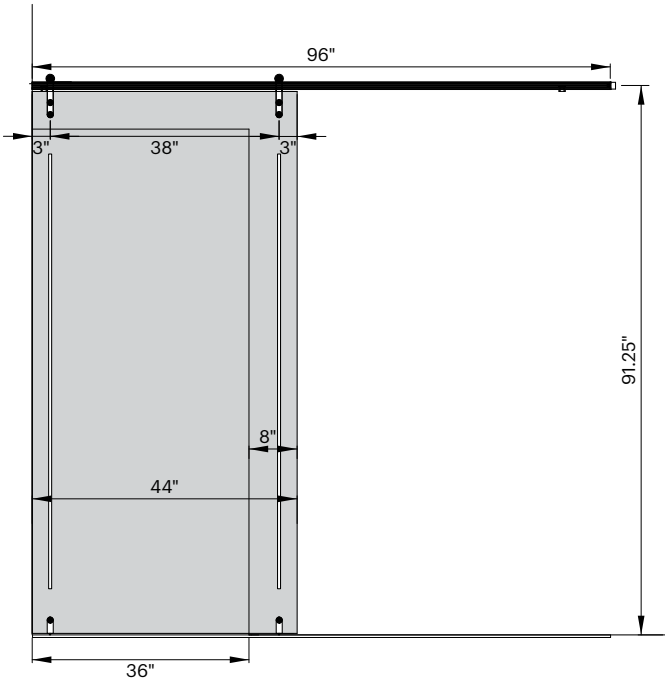

See Additional Considerations on page 3 prior to installation.

Installation

Tools You'll Need for Assembly

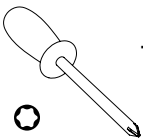

T25 Torx Head
Screw Driver

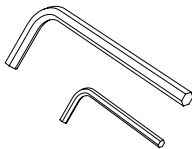

Metric
Allen Keys

Components List



Top Track
3-15-1630

2 piece top track extrusion set. May be cut on site or joined with additional track.



End Cap
3-15-1632

Used to cap end of top track



Track Splice
3-15-1633

Used to join 2 top tracks together.



Roller Assembly
3-15-0007

Used to suspend panel from the track.



Spring Loaded Pin
3-15-1626

Spring Loaded pin keeps in touch with the floor track.



Track Bumper
3-15-0008

Position on the track to limit the travel of the door.



U Guide w/Rollers
For 1/2" Material: 3-15-1621-K
For 5/8" Material: 3-15-1622-K
Use on the inside edge of the opening.
Rollers keep panel secure.



U Guide Receiver
For 1/2" Material: 3-15-1672-K
For 5/8" Material: 3-15-1623-K
Use on the far edge of the opening to receive the leading edge of the panel.



Recessed Track
3-15-1634

1/4" track may be recessed into the floor.



Stiffener/Handle
3-15-1645-K

Adds rigidity to the panel, as well as handle.



Fasteners
3-15-1607 / 3-15-0841

Washer Head fastener used to fasten base of top track to the wall.
Countersunk used on the floor.

Installation: KIT A (Floor Mounted Guides)

1 Mark the Location on the Wall for the Wall Mount Track

Vertical Location of Track (A):

The distance from the floor to the centerline of the track can easily be determined by taking your desired panel size and adding $\frac{1}{2}$ " for the bottom clearance and 1" for clearance between the track and the top of the panel. Using these values results in a tolerance of $+\frac{7}{16}$ " / $-\frac{1}{4}$ " in your installation to account for tolerance in the panel or in the unevenness of the floor.

Horizontal Location of Track (B):

The overlap between the track and opening of the door is largely a matter of preference. The diagram below assumes an equal overlap on both the R and L sides of the opening. 2" minimum is required for the track bumper and end cap (this ensures the panel is at least flush with the opening in the closed position).

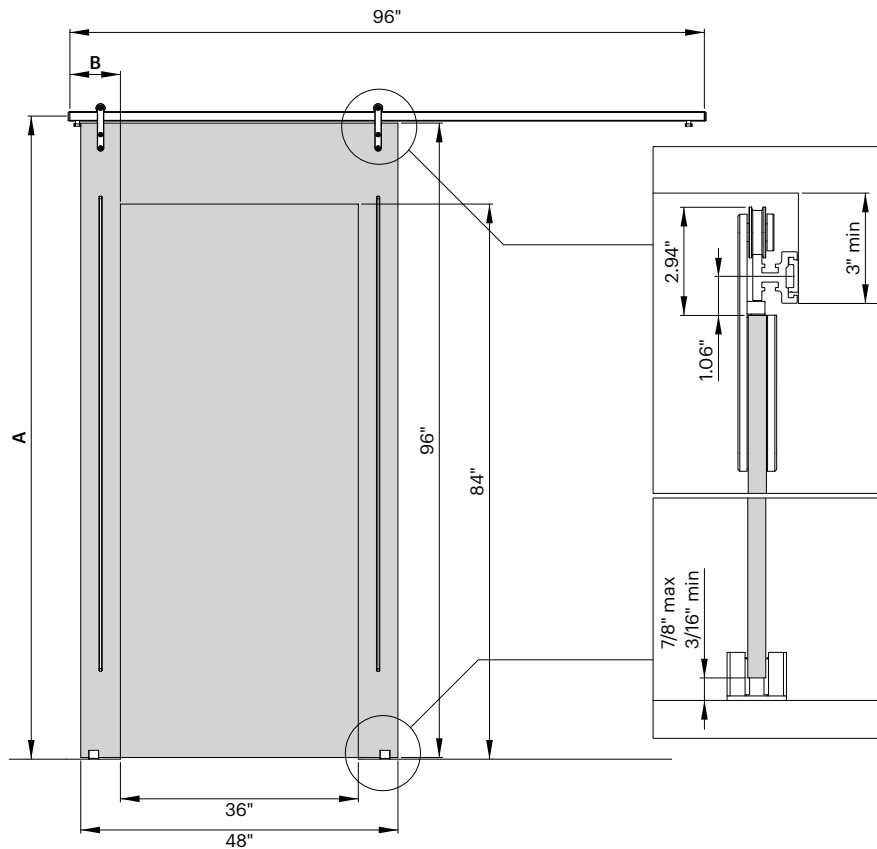

$$A = \text{Panel Size} + \text{Bottom Clearance} + \text{Top Details}$$

$$A = 96" + \frac{1}{2}" + 1"$$

$$A = 97\frac{1}{2}" (97\frac{1}{4}" \text{ min} / 97\frac{15}{16}" \text{ max})$$

$$B = \frac{(\text{Panel Size} - \text{Door Opening})}{2} + \text{Bumper and End Cap Clearance}$$

$$B = \frac{(48" - 36")}{2} + 2"$$

$$B = 8"$$

Installation: KIT A (Floor Mounted Guides)

2 Install the Track

- a** Cut the top track to desired length, if necessary. The wall substrate may require pre-drilling. 3form supplies a $\frac{5}{16}$ " \times $1\frac{1}{4}$ " T-25 torx head washer head fastener that is rated for concrete, cement block and wood. These items, including masonry drill bits matched to these fasteners, are available from 3form. Pre-drilling values are below.

Concrete: Pre-drill with optional $\frac{1}{8}$ " concrete drill bit (part ID 3-15-0839)

Cement: Pre-drill with optional $\frac{1}{8}$ " cement block drill bit (part ID 3-15-0840)

Wood: Pre-drill a $\frac{3}{64}$ " pilot hole for fasteners.

- b** After completing the items above, next mount the base of the track to the wall.

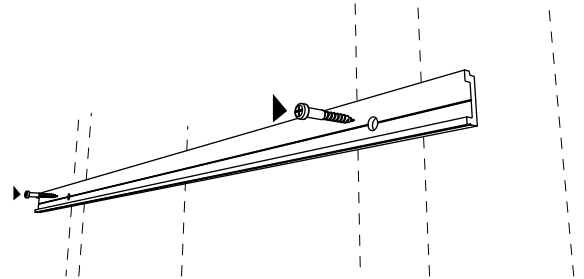

- c** The track is then easily fastened to the base.

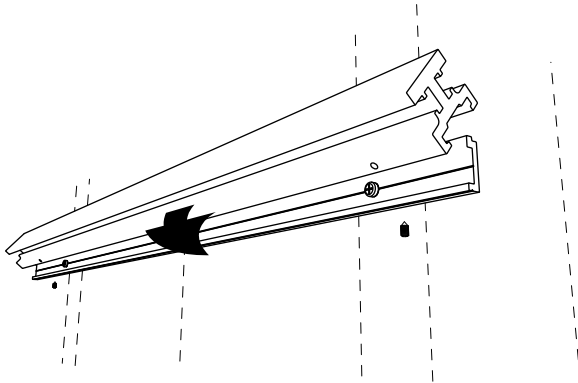

- d** Finally, tighten the set screws in the bottom of the track to secure it to the track base.

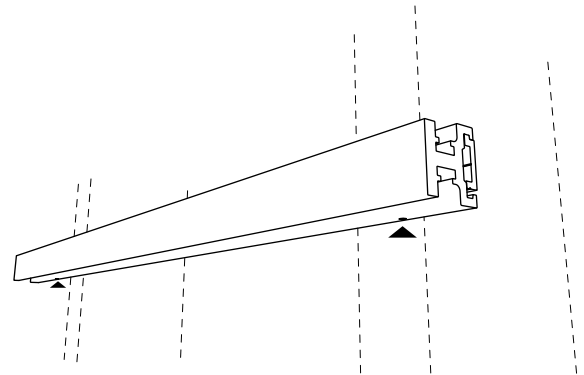

- e** *Note: Multiple tracks can be joined together by using the optional track splice plate. When joining multiple tracks, it is recommended to offset the seam between the wall base and the track.*

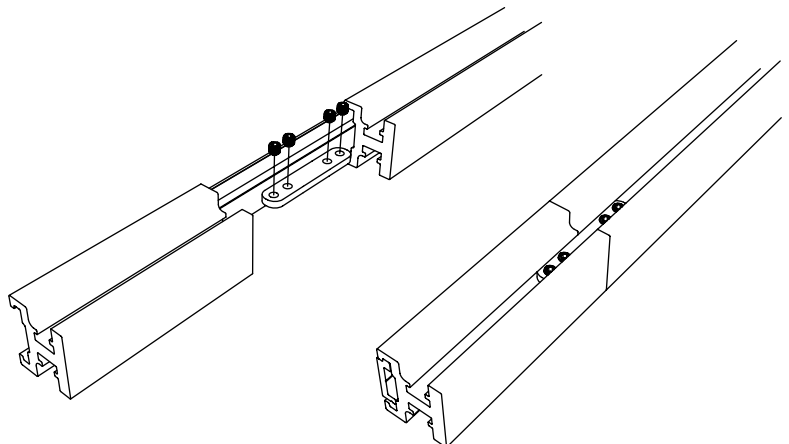

Installation: KIT A (Floor Mounted Guides)

3 Prepare the Panel (Roller Assembly)

- a 3form recommends pre-fabrication of the panel at 3form’s manufacturing facility at the time of ordering the panels. However, the panels may also easily be drilled in the field, according to the dimensions below.

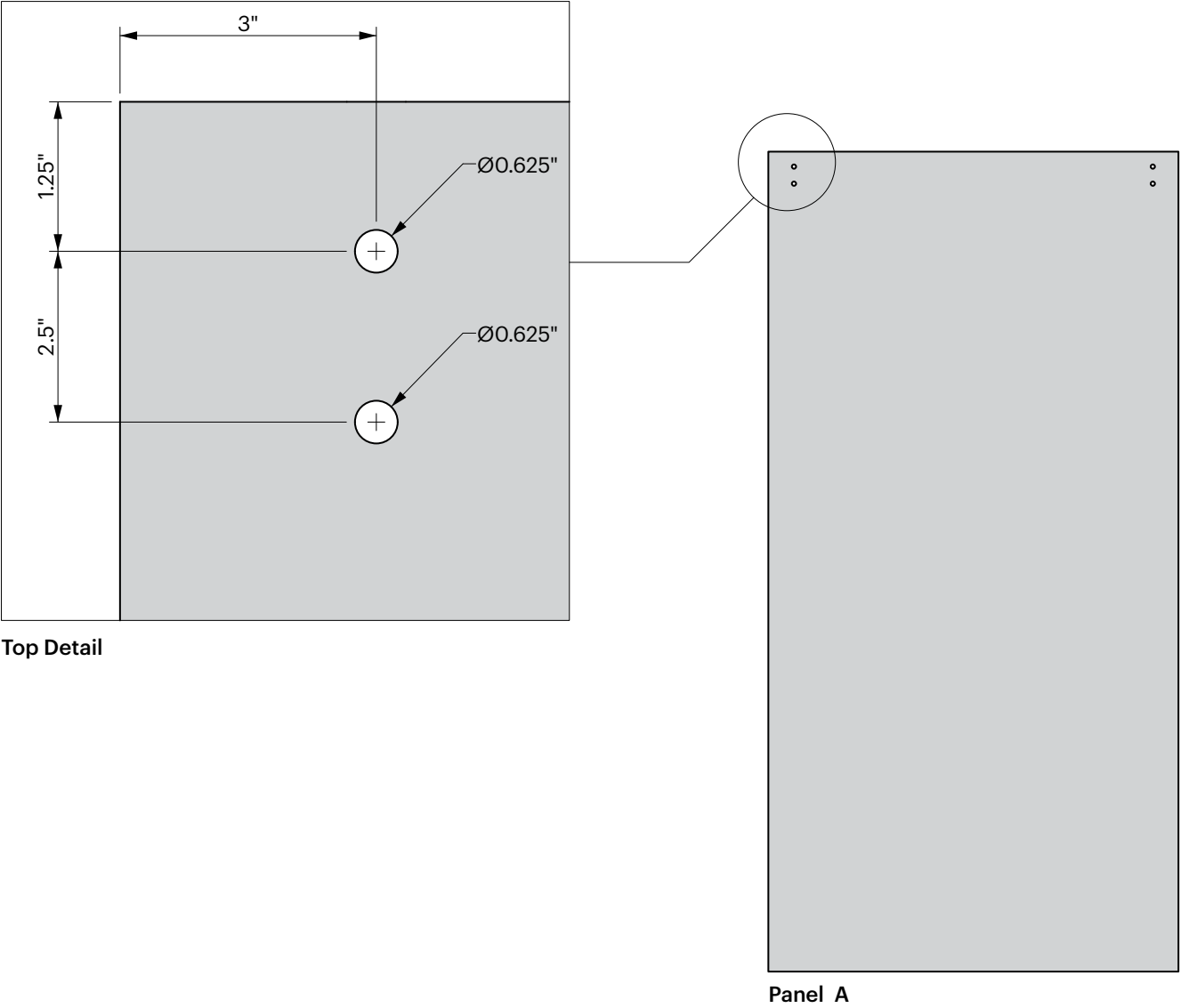

Installation: KIT A (Floor Mounted Guides)

3 Prepare the Panel (Stiffener/Handle)

- b** Each Slide WM kit ships with 2 stiffener handles designed to both add rigidity to the material as well as provide a simple handle for operation.

3form recommends placing the stiffener handles so that the top edge of the stiffener is approximately 7¼" from the bottom of the roller assembly and 3" in from the edge. This directly centers the handle stiffener in the middle of an 8' panel.

This recommendation requires (6) ⅛" diameter holes each 14" apart and directly in line with one another, per the images below.

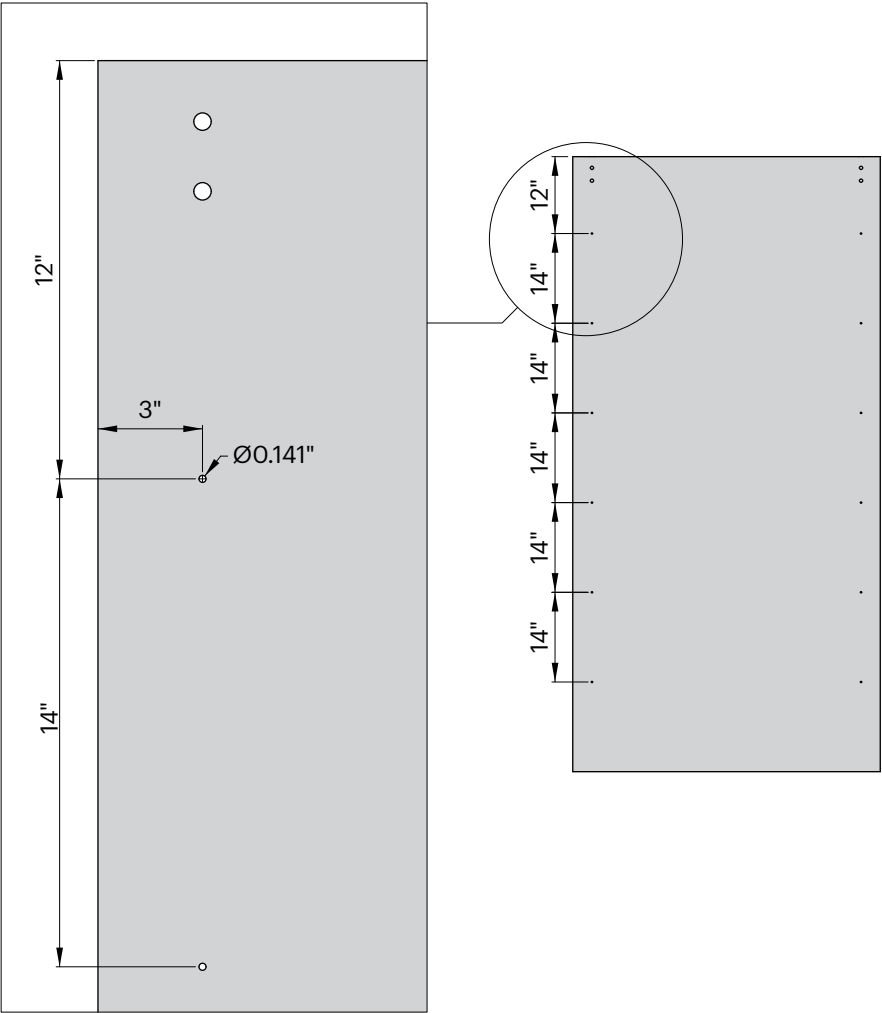

Installation: KIT A (Floor Mounted Guides)

4 Install Top Rollers on the Panel

- a** With the panel prepared, the hardware may now be attached to the panel, according to the illustration below.

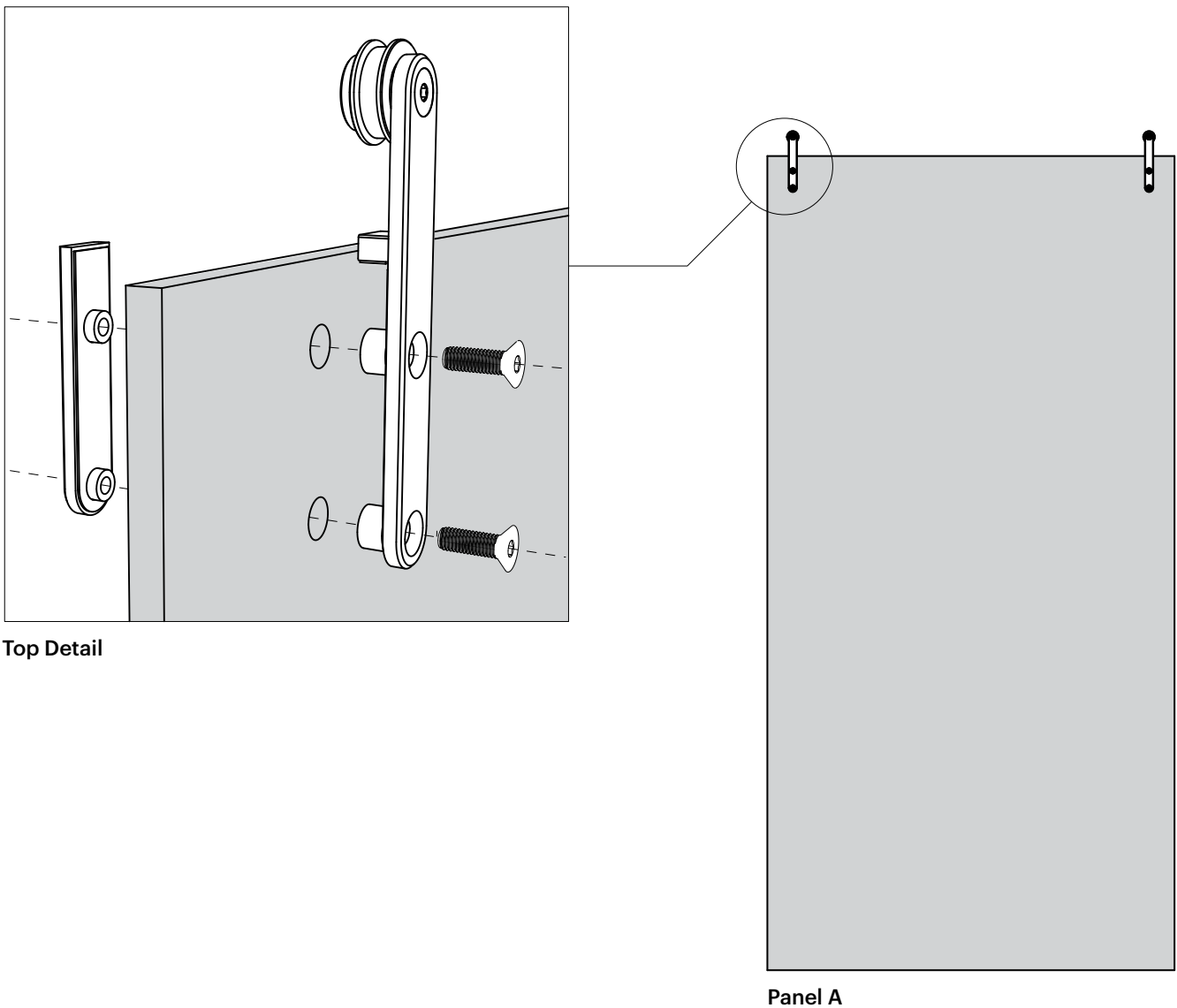

Installation: KIT A (Floor Mounted Guides)

4 Install Stiffeners/Handles on Panel

- b** When fastening the 2 piece stiffener/handle together, note that the shallow piece ($\frac{1}{2}$ " deep with countersunk holes) goes to the back of the panel, while the deeper piece ($\frac{3}{4}$ ") should be placed on the front of the panel.

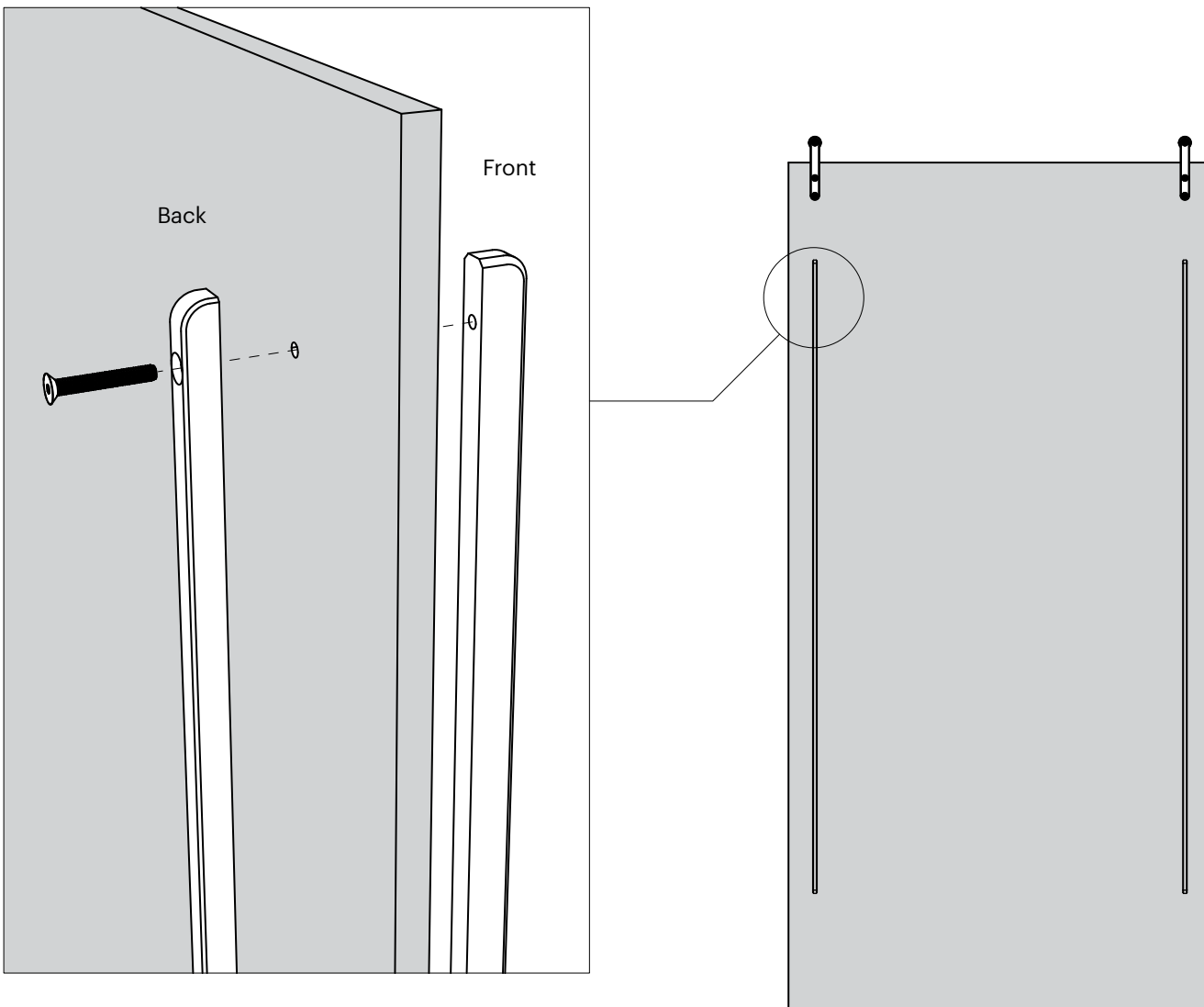

Panel A

Installation: KIT A (Floor Mounted Guides)

5 Install Floor Guides

The two floor guides should then be fastened to the floor. In each kit, there are 2 types of floor guide. One with rollers on the inside and one without. The floor guide without rollers is considered a receiver and should be placed on the far side of the opening into which the panel will slide into. The guide with rollers should be placed so that regardless of the position of the door, there is **always** contact between the panel the guide.

The guides are easily fastened directly to the floor with the included countersunk fasteners. If you do not wish to mark the floor with holes, double sided tape may be applied to the bottom of the guide to affix it to the floor.

Note: If the space is constrained horizontally (i.e. you cannot slide the door all the way to one side to clear the guides) you may have to 1) Install one guide, 2) hang the panel (see the next page), 3) install the receiver.

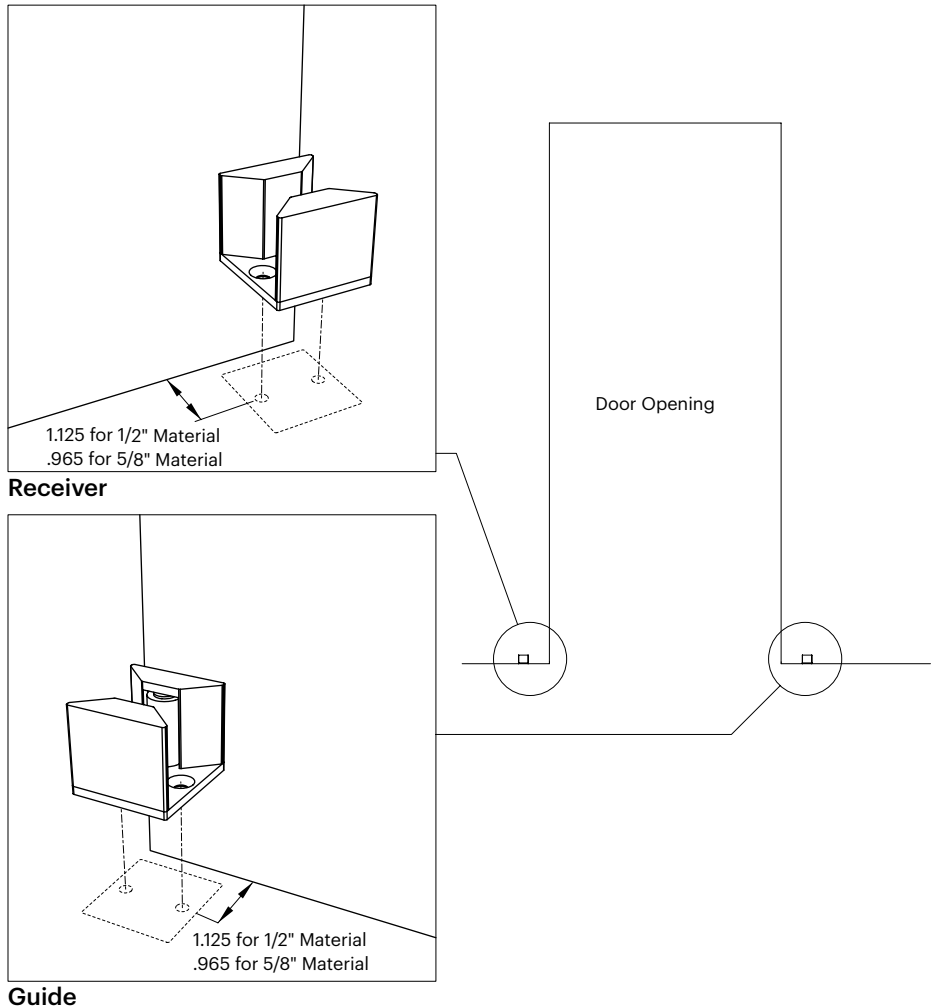

Installation: KIT A (Floor Mounted Guides)

6 Hang the Panel on the Track

Tilt the panel approximately 30 degrees and locate the roller wheel directly on the track. The panel may now swing down to a vertical position. The panel can then slide to one side or the other to allow it to slide between the guides.

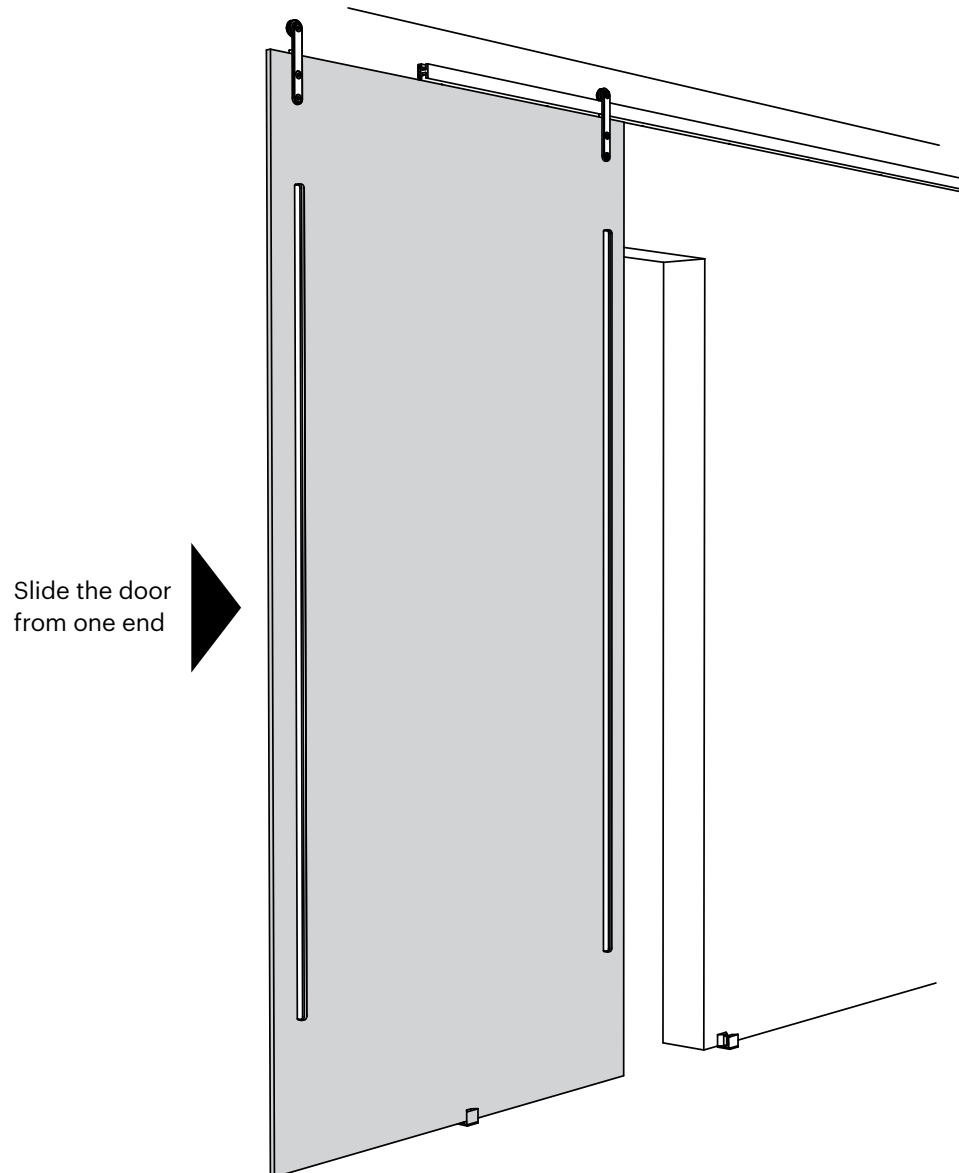

Installation: KIT A (Floor Mounted Guides)

7 Install Bumpers and End Caps

Slide the bumper into the track, correctly position, and fasten with included set screws. The end cap may now be inserted on the edge of the cap and secured into place.

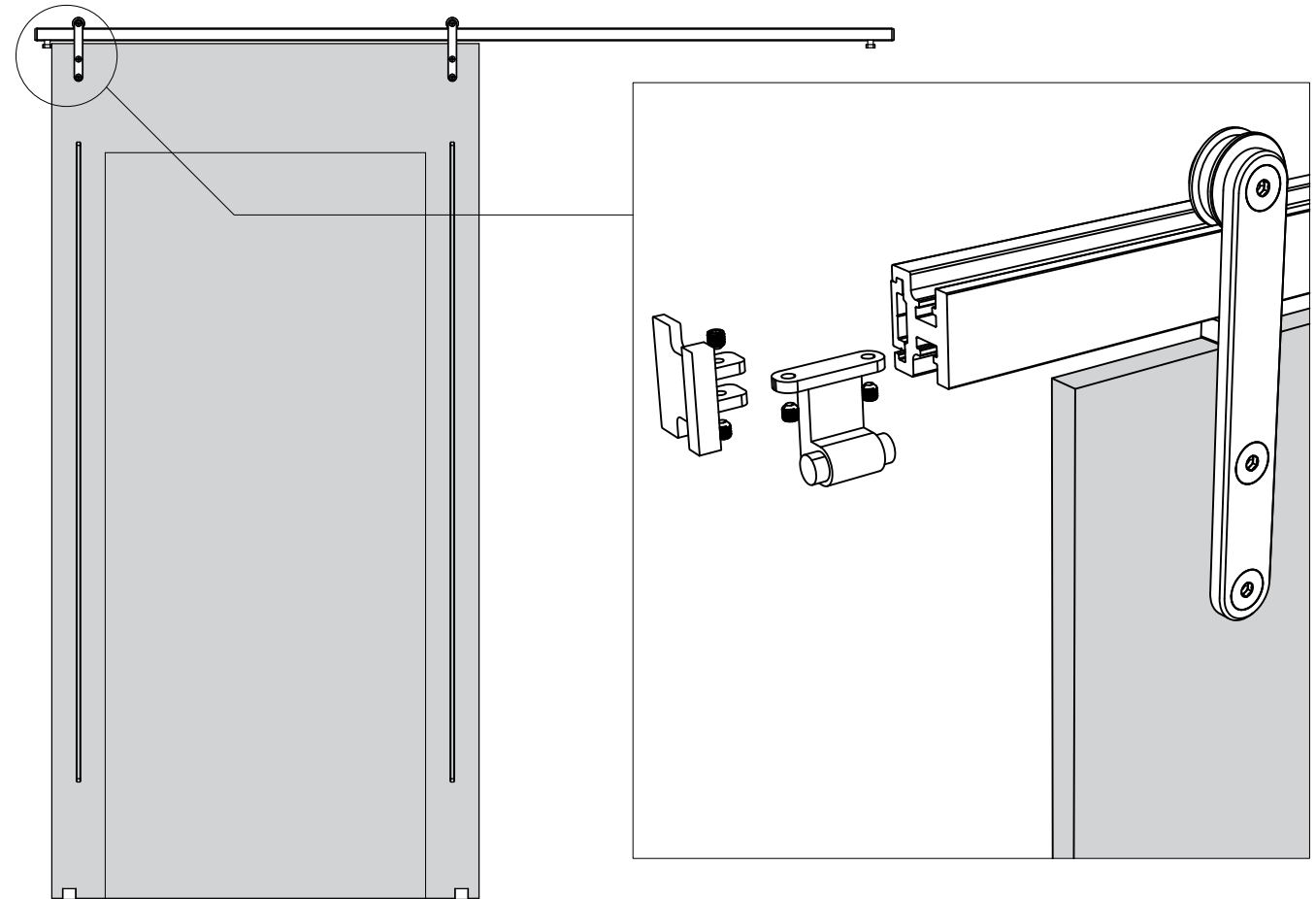

Installation: KIT B (Floor Track)

1 Mark the Location on the Wall for the Wall Mount Track

Vertical Location of Track (A):

The distance from the floor to the centerline of the track can easily be determined by taking your desired panel size and adding $\frac{3}{8}$ " for the bottom clearance and 1" for clearance between the track and the top of the panel. Using these values results in a tolerance of $\pm\frac{3}{16}$ " in your installation to account for tolerance in the panel or in the unevenness of the floor.

Horizontal Location of Track (B):

The overlap between the track and opening of the door is largely a matter of preference. The diagram below assumes an equal overlap on both the R and L sides of the opening. 2" minimum is required for the track bumper and end cap (this ensures the panel is at least flush with the opening in the closed position).

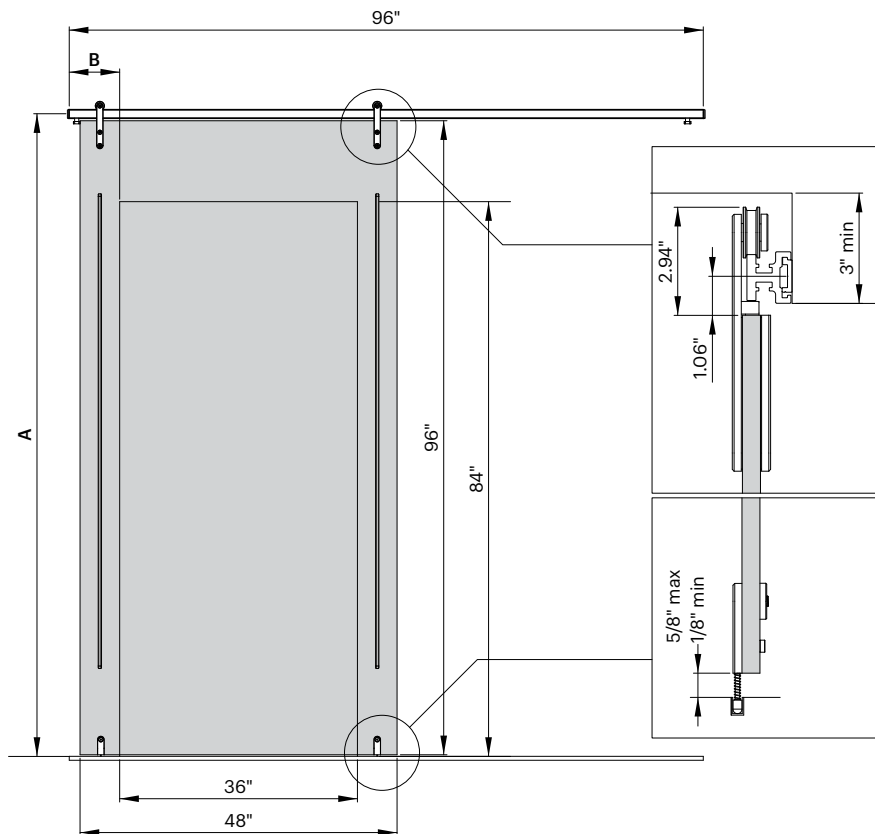

$$A = \text{Panel Size} + \text{Bottom Clearance} + \text{Top Details}$$

$$A = 96" + \frac{3}{8}" + 1"$$

$$A = 97\frac{3}{8}" \text{ (} 97\frac{3}{16}" \text{ min / } 97\frac{3}{16}" \text{ max)}$$

$$B = \frac{(\text{Panel Size} - \text{Door Opening})}{2} + \text{Bumper and End Cap Clearance}$$

$$B = \frac{(48" - 36")}{2} + 2"$$

$$B = 8"$$

Installation: KIT B (Floor Track)

2 Install the Track

- a** Cut the top track to desired length, if necessary. The wall substrate may require pre-drilling. 3form supplies a $\frac{5}{16}$ " \times $1\frac{1}{4}$ " T-25 torx head washer head fastener that is rated for concrete, cement block and wood. These items, including masonry drill bits matched to these fasteners, are available from 3form. Pre-drilling values are below.

Concrete: Pre-drill with optional $\frac{1}{8}$ " concrete drill bit (part ID 3-15-0839)

Cement: Pre-drill with optional $\frac{1}{8}$ " cement block drill bit (part ID 3-15-0840)

Wood: Pre-drill a $\frac{3}{64}$ " pilot hole for fasteners.

- b** After completing the items above, next mount the base of the track to the wall.

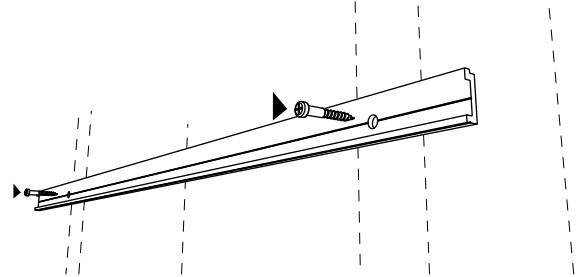

- c** The track is then easily fastened to the base.

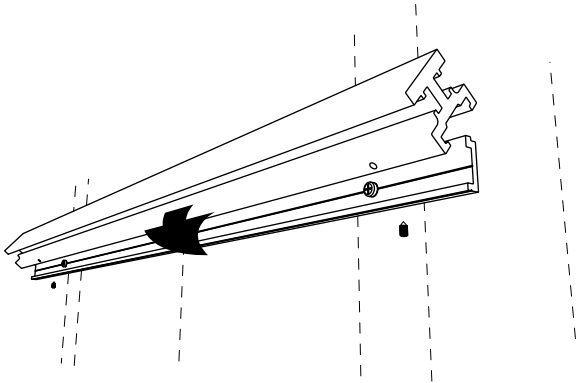

- d** Finally, tighten the set screws in the bottom of the track to secure it to the track base.

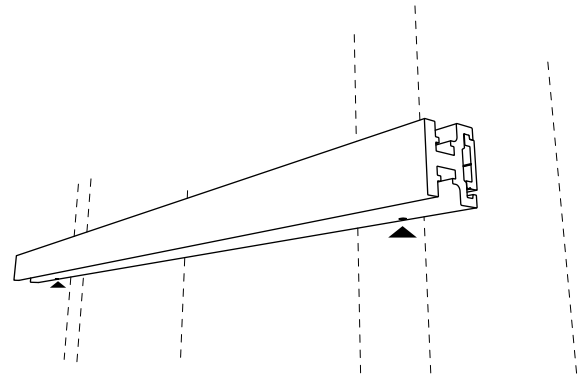

- e** *Note: Multiple tracks can be joined together by using the optional track splice plate. When joining multiple tracks, it is recommended to offset the seam between the wall base and the track.*

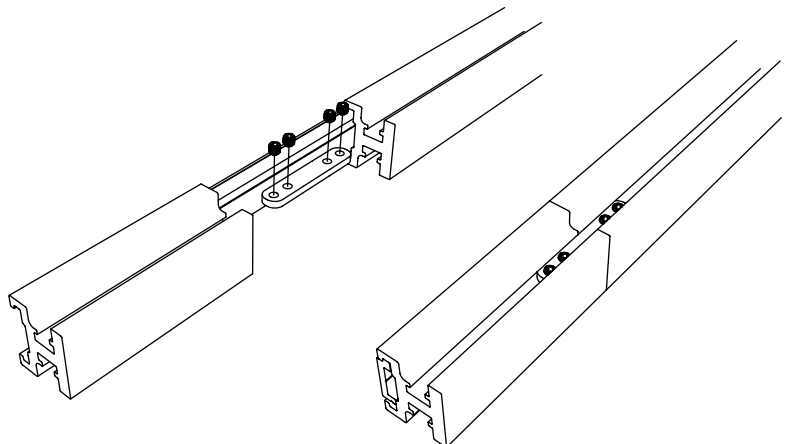

Installation: KIT B (Floor Track)

3 Prepare the Panel (Roller Assembly and Spring Loaded Pin)

- a 3form recommends pre-fabrication of the panel at 3form’s manufacturing facility at the time of ordering the panels. However, the panels may also easily be drilled in the field, according to the dimensions below.

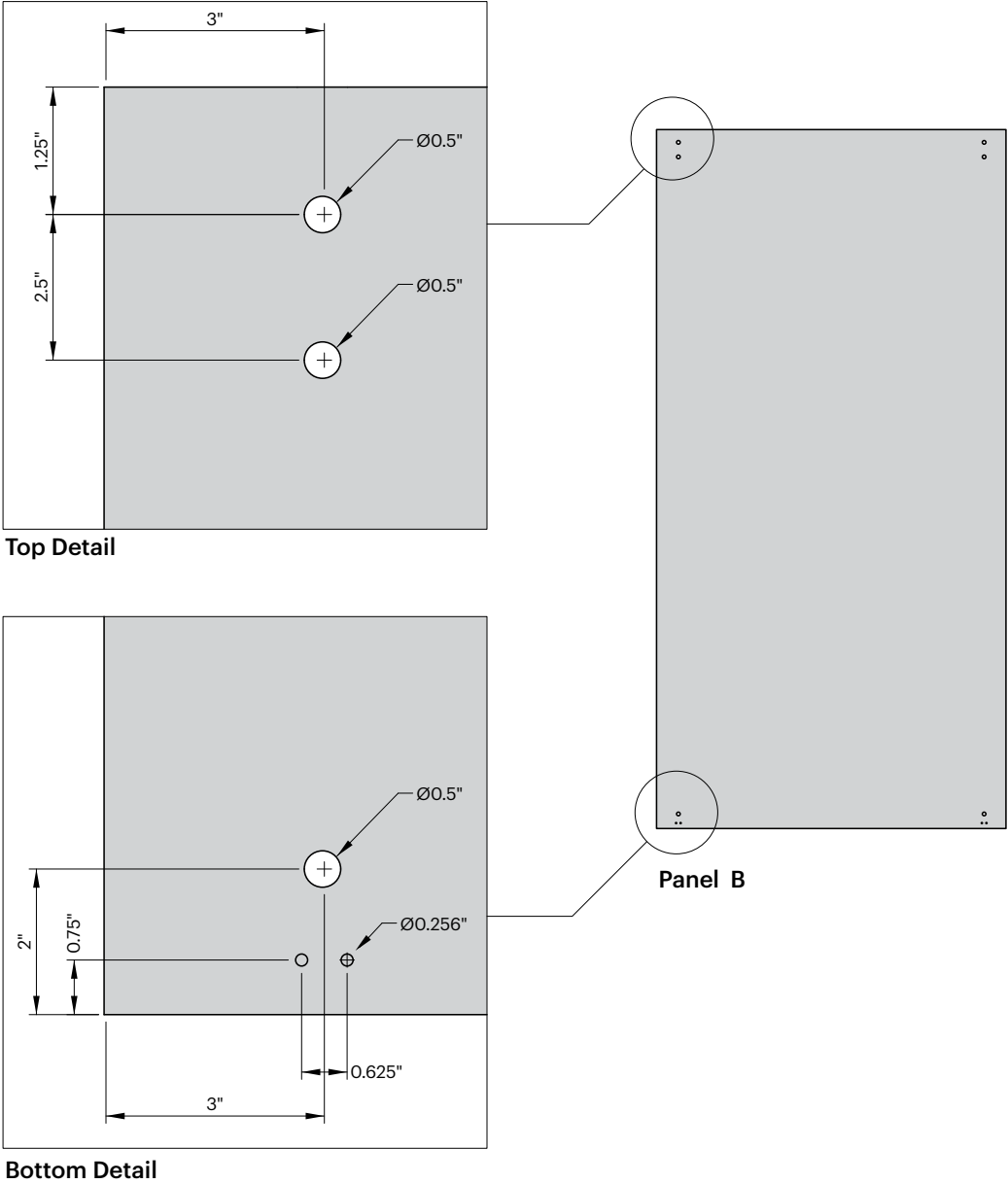

Installation: KIT B (Floor Track)

3 Prepare the Panel (Stiffener/Handle)

- b** Each Slide WM kit ships with 2 stiffener handles designed to both add rigidity to the material as well as provide a simple handle for operation.

3form recommends placing the stiffener handles so that the top edge of the stiffener is approximately 7¼" from the bottom of the roller assembly and 3" in from the edge. This directly centers the handle stiffener in the middle of an 8' panel.

This recommendation requires (6) ⅛" diameter holes each 14" apart and directly in line with one another, per the images below.

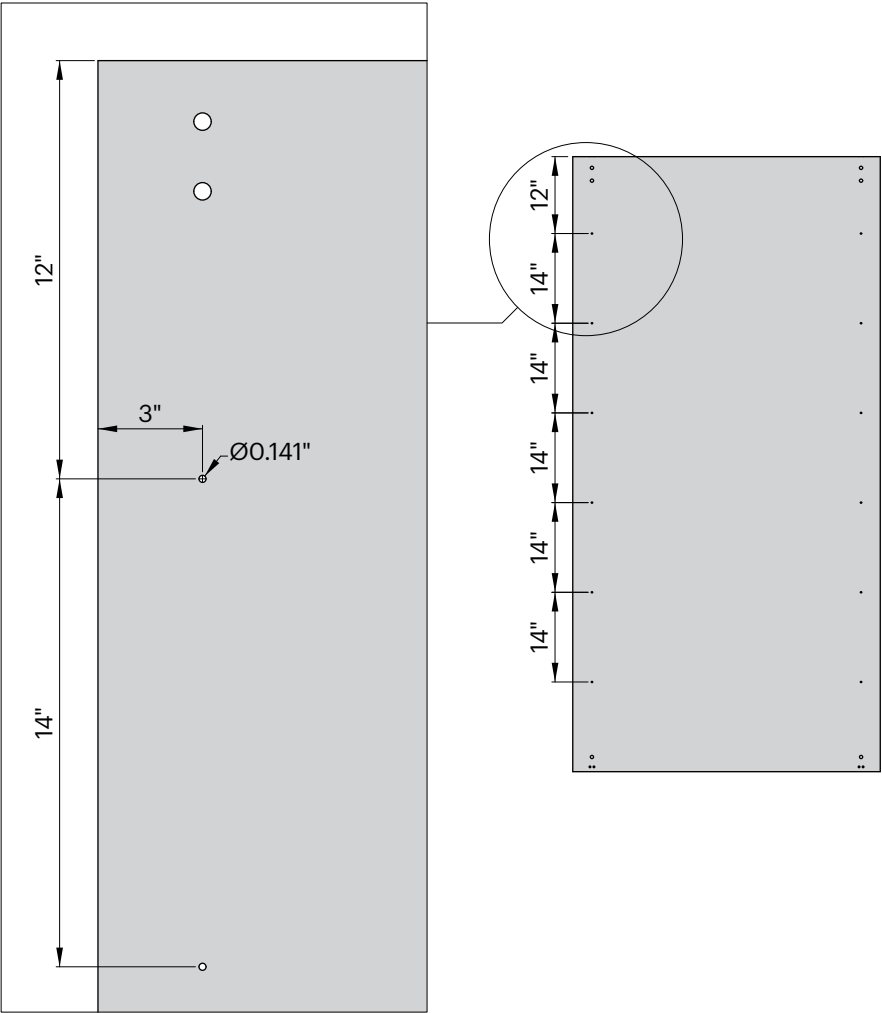

Installation: KIT B (Floor Track)

4 Install Top Rollers and Spring Loaded Pin on the Panel

- a** With the panel prepared, the hardware may now be attached to the panel, according to the illustration below. Note that the spring and pin will need to be held in place until the panel is hung on the track, or inserted after the panel is hung on the track.

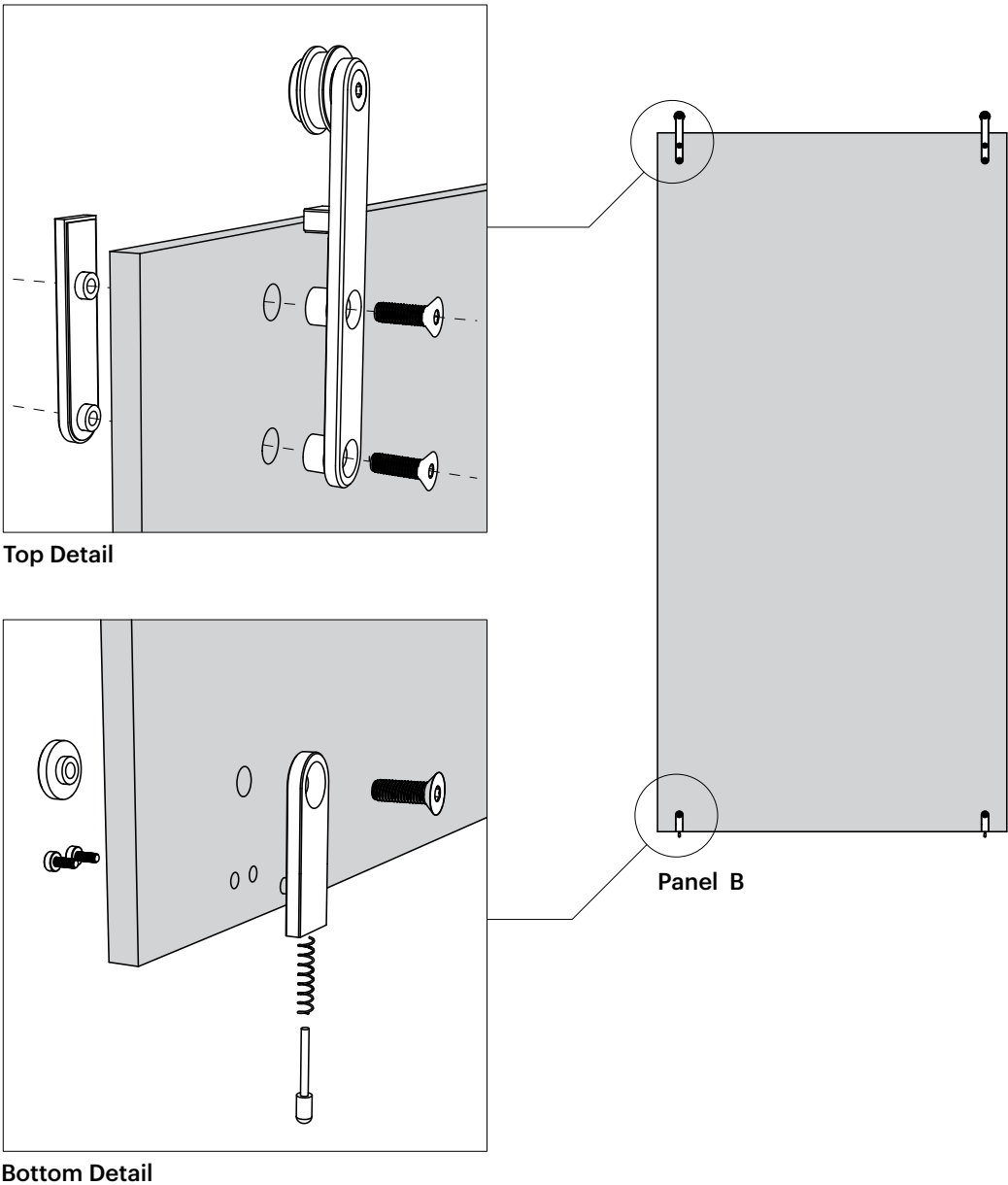

Installation: KIT B (Floor Track)

4 Install Stiffeners/Handles on Panel

- b** When fastening the 2 piece stiffener/handle together, note that the shallow piece ($\frac{1}{2}$ " deep with countersunk holes) goes to the back of the panel, while the deeper piece ($\frac{3}{4}$ ") should be placed on the front of the panel.

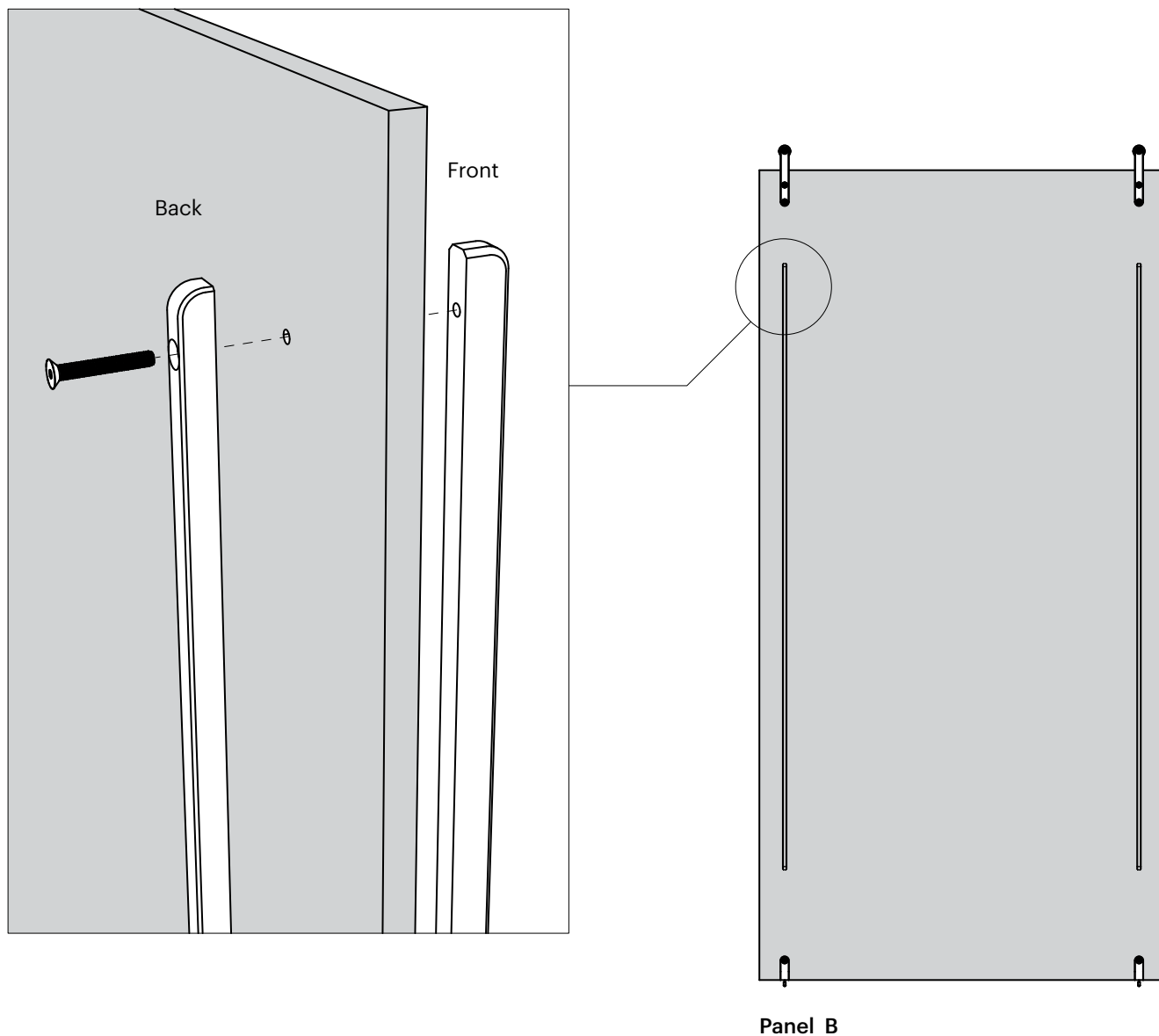

Installation: KIT B (Floor Track)

5 Install Floor Track

Rout out a section of the flooring $\frac{3}{8}$ " wide and $\frac{1}{2}$ " deep, approximately $1\frac{1}{4}$ " from the surface of the wall (note that if a baseboard is present, measure from the surface of the wall that the face plate is attached to not the baseboard).

Using a general construction adhesive, such as silicon or liquid nails, to fasten the track into the cut groove.

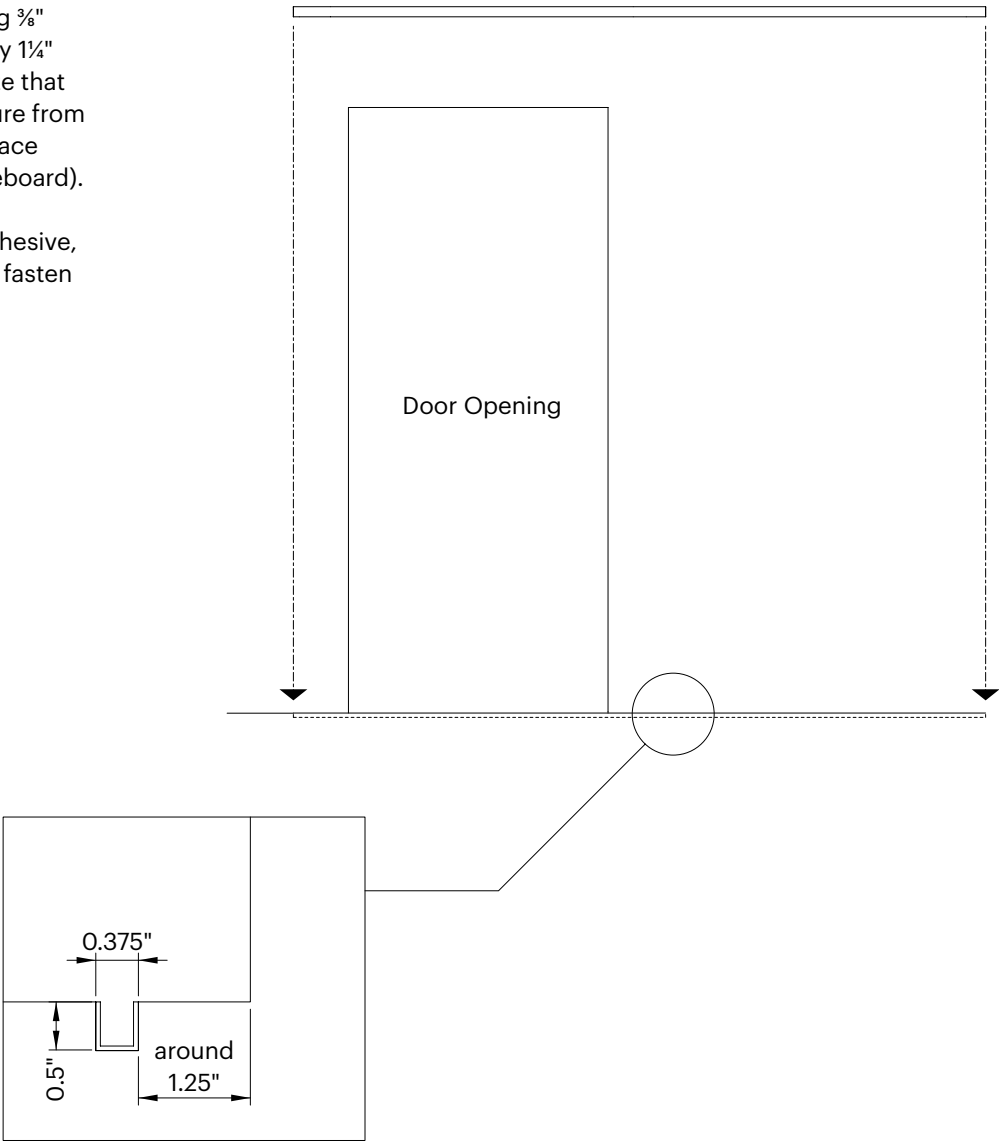

Installation: KIT B (Floor Track)

6 Hang the Panel on the Track

Tilt the panel approximately 30 degrees and locate the roller wheel directly on the track. The panel may now swing down to a vertical position. The panel can then slide to one side or the other to allow it to slide between the guides.

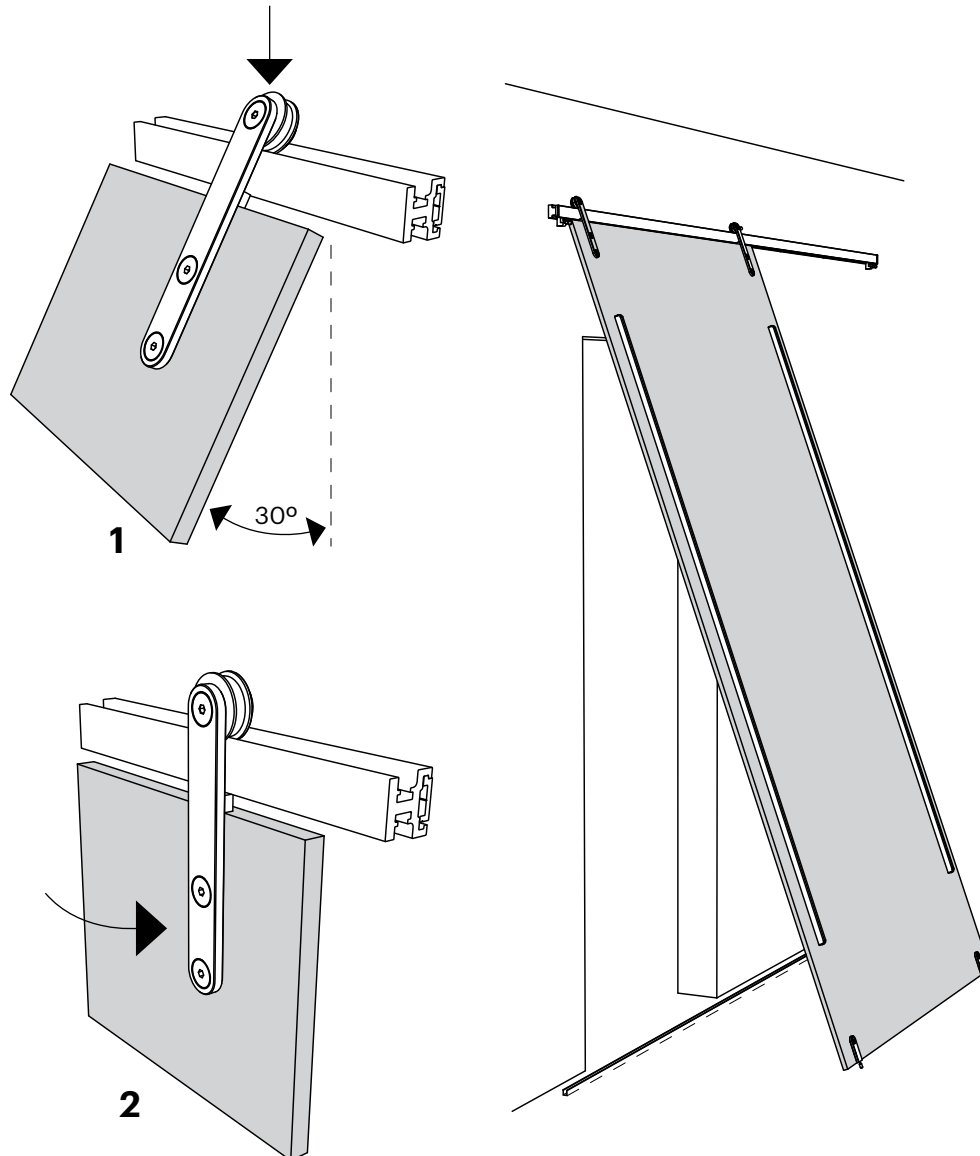

Installation: KIT B (Floor Track)

7 Install Bumpers and End Caps

Slide the bumper into the track, correctly position, and fasten with included set screws. The end cap may now be inserted on the edge of the cap and secured into place.

